

Instantaneous water heater DSX (before 07/2012)

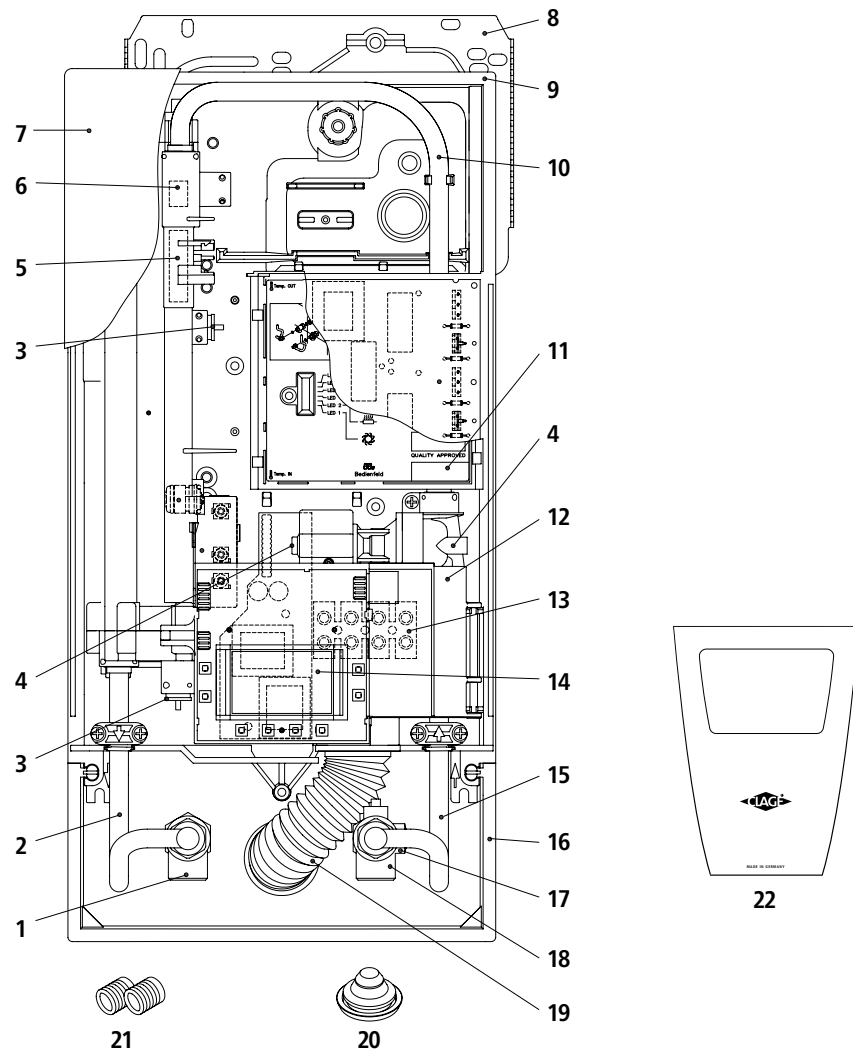

Pos.	Art.-No.	Description	Euro*	Pos.	Art.-No.	Description	Euro*
1	82085	Hot water connection	25.00	14	82551	DSX control panel	65.00
2	82529	Outlet pipe	12.00	15	82531	Inlet pipe	15.00
3	82512	DSX / DEX thermal sensor set	32.00	16	82571	Frame	6.00
4	82585	Servomotor with electronic	99.00	17	82162	Fine filter	5.00
5	82526	Flow sensor	14.00	18	82074	Cold water connection	25.00
6	82246	Non-return valve	6.00	19	82060	Water splash protection sleeve	5.00
7	82503	DSX hood	25.00	20	82180	Grommet	4.00
8	82520	Wall bracket	5.00	21	82110	Screw-in nipples 1/2"	4.00
9	82505	Bottom part	15.00	22	82504	Faceplate	7.00
10	82590	DSX connecting pipe	10.00				
11	82580	PCB cover	5.00	Not shown:			
12	82573	Control panel support	5.00	23	82598	Set of small spare parts	10.00
13	82572	Connecting terminal	4.00	Parts in bold type are key components for servicing purposes.			

When ordering, please always specify the appliance model and serial number from the rating plate. Further spare parts on request.

CLAGE GmbH
 Pirolweg 1–5, 21337 Lüneburg
 Fon: +49(0)4131·8901-0
 Fax: +49(0)4131·83 200
 E-mail: export@clage.de

Service:
 Fon: +49(0)4131·8901-40
 Fax: +49(0)4131·8901-41
 E-mail: service@clage.de
 Internet: www.clage.de